

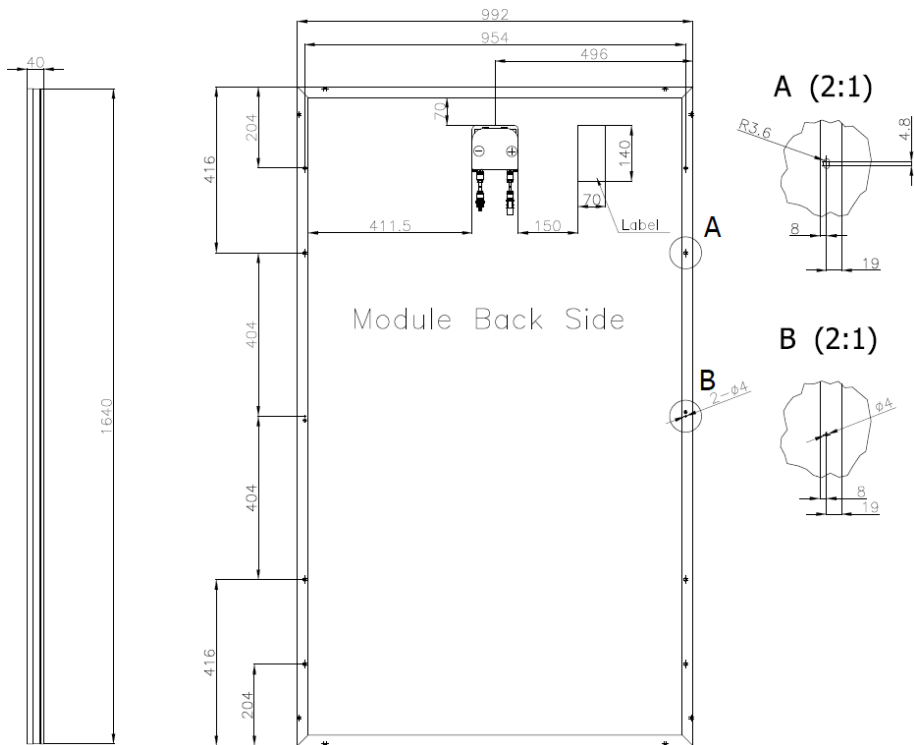

MM60-6RT Series

6" Mono-crystalline Solar Cell, 6x10pcs



Unit: in [mm]



Product Characteristics

Physical Specifications

| | |
|------------------------------|--|
| Dimension [L x W x H] | 64.57 x 39.06 x 1.57in (1640 x 992 x 40mm) |
| Module Area | 17.55 sq. ft (1.63 m ²) |
| Weight | 39.68 lb (18.0 Kg) |

Electrical Characteristics: Performance at STC*1

| Model Type | MM60-6RT-240 | MM60-6RT-245 | MM60-6RT-250 | MM60-6RT-255 | MM60-6RT-260 | MM60-6RT-265 |
|-----------------------------------|--------------|--------------|--------------|--------------|--------------|--------------|
| Peak Power Rating, Pmax | 240W | 245W | 250W | 255W | 260W | 265W |
| Power Tolerance | -0 / +5W | -0 / +5W | -0 / +5W | -0 / +5W | -0 / +5W | -0 / +5W |
| Peak Power Voltage, Vmp | 29.33 | 29.45 | 29.56 | 29.67 | 30.12 | 30.28 |
| Peak Power Current, Imp | 8.19 | 8.34 | 8.5 | 8.61 | 8.74 | 8.78 |
| Open Circuit Voltage, Voc | 36.89 | 37.07 | 37.19 | 37.3 | 37.87 | 38.06 |
| Short Circuit Current, Isc | 8.74 | 8.83 | 8.91 | 8.97 | 9.1 | 9.15 |
| Module Efficiency | 14.72% | 15.03% | 15.34% | 15.64% | 15.95% | 16.26% |

| Model Type | MM60-6RT-270 | MM60-6RT-275 | MM60-6RT-280 | MM60-6RT-285 | MM60-6RT-290 |
|-----------------------------------|--------------|--------------|--------------|--------------|--------------|
| Peak Power Rating, Pmax | 270W | 275W | 280W | 285W | 290W |
| Power Tolerance | -0 / +5W | -0 / +5W | -0 / +5W | -0 / +5W | -0 / +5W |
| Peak Power Voltage, Vmp | 30.58 | 30.84 | 31.1 | 31.37 | 31.63 |
| Peak Power Current, Imp | 8.87 | 8.97 | 9.06 | 9.16 | 9.25 |
| Open Circuit Voltage, Voc | 38.44 | 38.75 | 39.08 | 39.4 | 39.73 |
| Short Circuit Current, Isc | 9.24 | 9.33 | 9.41 | 9.49 | 9.58 |
| Module Efficiency | 16.56% | 16.87% | 17.18% | 17.48% | 17.79% |

*STC: Standard Test Condition, 1000W/m², AM 1.5, 25°C

Packing Specifications

| | |
|--------------------------------------|---|
| Modules Per Carton | 12pcs/Carton |
| Modules Per Pallet | 24pcs/Pallet (=2 Cartons/Pallet) |
| Pallet Dimension [L x W x H] | 66.3 x 44.7 x 43.9 in (1685 x 1134 x 1114 mm) |
| Pallet Weight | 1134 Lbs (514Kg) |
| 20ft Container Capacity (pcs) | 288 |
| 40ft Container Capacity (pcs) | 672 |

System Integration Parameter & Safety Rating

| | |
|---|---|
| Maximum System Voltage (U.S. & Canada) | 600VDC |
| Maximum System Voltage (Area Not in the U.S. & Canada) | 1000VDC (According to Norms in Each Area) |
| Series Fuse Rating | 15A |
| Fire Safety Class | Class C |
| Application Class | Class A (Safety Class II) |
| Environmental Operating Temperature (°F, °C) | -40 to 185°F, -40 to 85°C |

Limited Warranty***

| | |
|-------------------------|---------|
| Product | 10Years |
| 90% Output Power | 10Years |
| 80% Output Power | 25Years |

***For details, please read our warranty letter.

Component materials

| | |
|------------------------------|--|
| Cell Qty per Module | 60pcs |
| Cell Type | Mono-crystalline Silicon |
| Cell Dimensions | 6 x 6 in (156 x 156 mm) |
| Laminate Construction | Front: Tempered Glass Encapsulation: Solar Cells Embedded in EVA (Ethylene-Vinyl-Acetate) Rear: Tedlar Color of back sheet: White |
| Glass | Low-Iron Tempered Glass Standard thickness: 0.126in (=3.2mm) (>0.126in (=3.2mm), ex. 0.157in (=4mm) or above, custom-made possible.) |
| Junction Box | IP65, Kit with Solar Cables & Connectors, TÜV Certified & UL Listed |
| Bypass Diodes | 3pcs, TÜV Certified & UL Listed |
| Cable | Solar Cable x2 (Kit with Junction Box & Connector) Cable Length: 39.37/39.37in. (1000/1000mm) Wire Size: AWG #12, 4.0mm ² , TÜV Certified & UL Listed |
| Connector | Yukita Connectors, x2 (Male Coupler x1 + Female Coupler x1) MC4 Connectors (Optional), x2 (Male Coupler x1 + Female Coupler x1) TÜV Certified & UL Listed |
| Frame | Anodized Aluminum Frame. Color: Silver or Black |

Thermal Characteristics

| | |
|--|-------------------|
| NOCT (Nominal Operating Cell Temperature) °F, °C | 115.70°F, 46.50°C |
| Temperature Coefficient TK I_{sc} (Short Circuit Current) α | +0.086%/°C |
| Temperature Coefficient TK V_{oc} (Open Circuit Voltage) β | -0.288%/°C |
| Temperature Coefficient TK P_{max} (Peak Power) γ | -0.403%/°C |